



Bluetooth Headset Manual

Model# HFBLU-LT100



Contents

Introduction.....	1
HFBLU-LT100 Bluetooth Headset Overview	2
Pair to your Bluetooth phone	3
Charging the battery	4
Battery information.....	5
Turning headset on /off	5
Wearing your headset.....	6
Making a call	8
Ending a call	8
Reject an incoming call	8
Answering a call	9
Transferring a call	9
Call-waiting (Three-Way Calling)	9
Volume control & Mute function	9
Summary of button operation	10
Safety and general information.....	12
FCC & IC Statement	13
EU	13
Warranty	14

1 Introduction

The **HFBLU-LT100** Bluetooth Headset is a Bluetooth device developed with Bluetooth technology, which can connect to other Bluetooth devices such as a mobile phone, PDA, or notebook computer (with audio gateway profile supported) wirelessly to attain voice transferred purpose within a range of 10 meters.

Introduction of Bluetooth wireless Technology

Bluetooth is a short-range wireless communication technology. The Bluetooth wireless technology makes it possible to connect any compatible portable and stationary communications device without using cables. The technology is based on a radio link that offers fast and reliable transmission of voice and data information. Bluetooth refers to a worldwide standard designed to operate in the internationally recognized ISM (Industrial Scientific and Medical) frequency band. Within the ISM band (2.4GHz~2.485GHz), Bluetooth transmissions hop between 79 separate frequencies 1.600 times every second, and with a communication range of about 10 meters.

Box Content

- HFBLU-LT100** Bluetooth Headset
- AC Charger
- Ear Hook
- Ear Gel
- User Manual

2 HFBLU-LT100 Bluetooth Headset Overview

Front

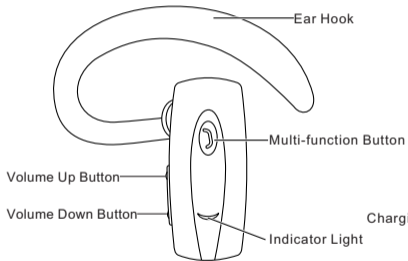

Back

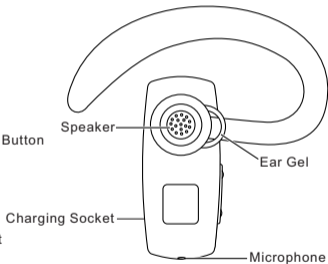

3 Pair to your Bluetooth phone

Before you use your headset for the first time, ensure that it is paired to use it with devices such as your Bluetooth phone.

Once you pair the headset with a device, the headset will be automatically connected to the device whenever you turn the headset on.

Ensure the headset is off.



Press and hold the Multi-function Button until you see blinking blue and red light. (Approximately 6 seconds), then release.



Set your Bluetooth phone to "discover" the headset by following your phone's instruction guide. Typically, "Bluetooth" menu on your phone and then selecting the option to "discover" a Bluetooth device.



Your phone will find your headset and ask if you want to pair with it. Confirm this by pressing "YES" or "OK".



Enter passkey or PIN=0000 (4 zeros), then press "YES" or "OK".

IMPORTANT!

When the headset paired with mobile phone, the indication light will flash 1 time every 3 seconds. If failed, the blue indicator light will flash 1 time every 5 seconds.

4 Charging the battery

This device has an internal, nonremovable, rechargeable battery. Do not attempt to remove the battery from the device as you may damage the device.

1. Connect the charger to the correct outlet.
2. While the charger is connected, the red indicator light is displayed during charging. If charging does not start, disconnect the charger, plug it in again, and retry.
Charging the battery fully may take up to 2 hours.
3. When the battery is fully charged, the red indicator light turns off. Disconnect the charger from the headset and the wall outlet.



The fully charged battery has power for up to 5 hours of talk-time or up to 150 hours of standby time. However, the talk and standby times may vary when used with different mobile phones or other compatible Bluetooth devices, usage settings, usage styles, and environments. When battery power is low, the headset will remind you by beeps every 20 seconds, and the red indicator light will also flash.

IMPORTANT NOTICE!

1. For first time use, please charge the headset fully . If you cannot see the indicator light when charging, please leave the headset charging for a while (Approx 15-35 Minutes), the indicator light will then illuminate.
2. If after a full charge, you cannot turn the headset on, please reconnect the headset to the charger for a few seconds to activate it.

5 Battery information

Your device is powered by a chargeable battery. The full performance of a new battery is achieved only after two or three complete charge and discharge cycles. The battery can be charged and discharged hundreds of times, but it will eventually wear out.

Unplug the charger from the electrical plug and the device when not in use. Do not leave a fully charged battery connected to a charger, since overcharging may shorten its lifetime. If left unused, a fully charged battery will lose its charge over time.

If the headset is left unused for a long time, please turn off and fully charge the headset. To prevent over-discharge, which will endanger the battery, you are recommended to charge the headset fully each month.

Never use a charger that is damaged.

6 Turning headset on /off

	How to act	Tones	Indicators
Turning on the headset	Press and hold the Multi-function Button for 2 seconds until you see a blue indicator flashing, then release it.	Turn-ON melody	The blue indicator will flash indicating the power is on.
Turning off the headset	Press and hold the Multi-function Button for 4 seconds until you see a red indicator flashing, then release it.	Turn-Off melody	After red indicator flash, it will be turned off.

Please note: To conserve power, the headset will automatically turn off if it detects that it is not connected to a device for more than 10 minutes.

7 Wearing your headset

The headset is provided with an ear hook that you can use for a better fit on your ear.

To use the headset without the ear hook, plug the headset into your ear (1), and point the headset toward your mouth.

To use the headset with the ear hook, insert the ear hook into the speaker post at the back of the headset (2). To wear the headset on the right ear, slide the ear hook over your ear, and push or pull the ear hook to set its length (3). Set the headset so that it points toward your mouth.

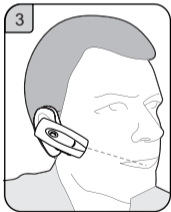
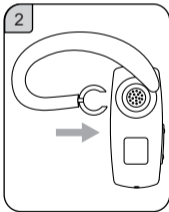
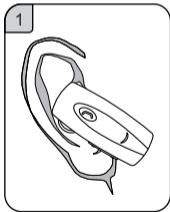

To adjust the ear hook (ear gel) for right-ear use



To adjust the ear hook (ear gel) for left-ear use

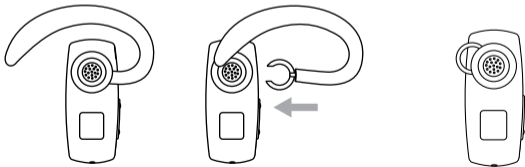

8 Making a call

*** Using phone's keypad**

- (1) Dial number on keypad.
- (2) Press phone's "send" key.

*** Using voice-activated dialing**

Please check if your mobile phone supports voice dialing function. If your phone does support this function, please follow your mobile phone manual instructions for set up.

- (1) Press the Multi-function Button briefly, then you can hear a short beep.
- (2) Say the name of person you wish to call.
- (3) If the voice tags are paired to the related phone number stored in you mobile phone, the number will be dialed.

*** Last number dialing**

Please check if your mobile phone supports the redial function.

- (1) Press the Volume Down Button for 2 seconds.
- (2) You can hear a short beep.

9 Ending a call

Press the Multi-function Button briefly from the headset while you are on the line. You can also end call from your mobile.

10 Reject an incoming call

When you receive an incoming call, press and hold the Multi-function Button for 2 seconds and then release.

11 Answering a call

When you receive an incoming call, press the Multi-function Button briefly.

12 Transferring a call

(1) Headset to phone: Press Volume Up Button for 2 seconds.

(2) Phone to headset: Press Volume Up Button for 2 seconds.

13 Call-waiting (Three-Way Calling)

Before using 3 way calling with your headset, you must ensure that your phone supports the Hands-free Profile and that the "call hold and/or multiparty" services are available in the network.

(1) Press the Multi-function Button briefly to accept or receive waiting(incoming) call and end active call.

(2) Press the Multi-function Button for 2 seconds to accept waiting(incoming) call and hold active call.

14 Volume control & Mute function

You can adjust the volume by pressing volume up and volume down button.

Press and hold the Volume Down Button for 2 seconds, you will hear short beeps low to high. The headset MIC will then be muted and you will hear a remindful melody every 10 seconds. Deactivate the mute function by pressing the Volume Down Button for 4 seconds, you will hear short beeps, low to high first, and then hear short beeps, high to low, indicating the mute function has been cancelled.

15 Summary of button operation

Button	ACTION	HEADSET STATUS		
		Standby (No Calls Active)	Incoming Call	1 call Active
Multi- function Button	Quick Press	Initiate voice dialing	Answer call	End call
	2 Seconds	–	Reject call	–
	4 Seconds	Turn headset OFF	Turn headset OFF	Turn headset OFF
Volume Up	Quick Press	Increase volume	Increase volume	Increase volume
	2 Seconds	–	–	Transfer active call to/from phone
	4 Seconds	–	–	–
Volume Down	Quick Press	Decrease volume	Decrease volume	Decrease volume
	2 Seconds	–	–	Microphone mute ON
	4 Seconds	–	–	Microphone mute OFF

Button	ACTION	HEADSET STATUS	
		1 Call Active, 1 Incoming Call	1 Call Active, 1 Call on Hold
Multi-function Button	Quick Press	Answer incoming, end active	End active, retrieve held call
	2 Seconds	Answer incoming, hold active	Swap Calls
	4 Seconds	Turn headset OFF	Turn headset OFF
Volume Up	Quick Press	Increase volume	Add held call to 3-way-calling
	2 Seconds	–	Transfer active Call to/from Phone
	4 Seconds	–	–
Volume Down	Quick Press	Decrease volume	Add held call to 3-way-calling
	2 Seconds	–	–
	4 Seconds	–	–

Please note: The desired function is initiated only when the button is released. It is important that the button is held for the correct period of time.

16 Safety and general information

1. Please read this guidebook carefully and follow the instructions.
2. To avoid any damage or malfunction of the device do not drop device from high places.
3. Keep device away from humidity, water and any other liquid. If the device is exposed to water, moisture and other liquid, do not operate it to avoid any electrical shock, explosion and damage to the device or yourself.
4. Do not place or keep this device near any heat sources, such as, direct sun light, radiators, stoves or other apparatus which produce heat. It may cause explosion, degrade the performance and/or reduce battery life.
5. Do not modify, repair or disassemble device at discretion (Especially battery: It may cause an explosion). Doing this will void the warranty.
6. Do not place the heavy objects on the device.
7. Use only supplied and approved charger.
8. Replacement or service must be done by qualified service center or manufacturer.
9. Unplug this device when unused for long periods of time or during lightning storms.



CAUTION: ELECTRIC SHOCK HAZARD

The battery used in this device may present a risk of fire or chemical burn if mistreated.

17 FCC & IC Statement

Operation is subject to the following two conditions:

- (1) This device may not cause harmful interference, and
- (2) This device must accept any interference received, including interference that may cause undesired operation.

Note: The manufacturer is not responsible for ANY interference, for example RADIO or TV interference, caused by unauthorized modifications to this equipment.

Such modifications could void the user's authority to operate the equipment.

18 EU

This product is CE certified according to the provision of the R&TTE Directive (99/5/EC). Declares that this product is in compliance with the essential requirements and other relevant provisions of Directive 1999/5/EC.

Please note that this product uses radio frequency bands not harmonized within EU. Within the EU this product is intended to be used in Austria, Belgium, Denmark, Finland, France, Germany, Greece, Ireland, Italy, Luxembourg, The Netherlands, Portugal, Spain, Sweden, United Kingdom and within EFTA in Iceland, Norway and Switzerland.

Bluetooth is a trademark owned by the BluetoothSIG, Inc.

19 Warranty

The condition of this warranty and our responsibilities under this warranty are as follows: Warranty is non-transferable and is limited to the original purchaser only.

- * You must be able to prove the date of original purchase of the unit with a dated receipt.
- * The warranty is not applicable if the product has been subject to physical abuse, improper installation, modification or repair by unauthorized third party.
- * The responsibility of supplier's products shall be limited to the repair or replacement of the product at its sole discretion.
- * Specifically exempt from any warranty are limited-life consumable components subject to normal wear and tear such as batteries, decorates and other accessories.
- * Supplier will not take any responsibility if the failure of the unit has resulted from accident, abuse, misuse, or any unauthorized repair, modification or disassemble.
- * Modification and repair of the unit should be done by authorized and qualified service center or returned to the manufacturer
- * This warranty gives you specific legal rights, and you may also have other rights which vary under local laws.



Mizco International inc.
140 58th street
Building B, Suite 1F
Brooklyn NY, 11220
Toll Free: 800.266.4026

MADE IN CHINA